

Explosion Proof Emergency Stop Switches



(P) versions include button protection shroud and padlock holes for lock off.



ESL-SS(P)-Ex



ESL-SS-Ex

Zones 1 and 2

Zones 21 and 22

Gas and Dust IP67

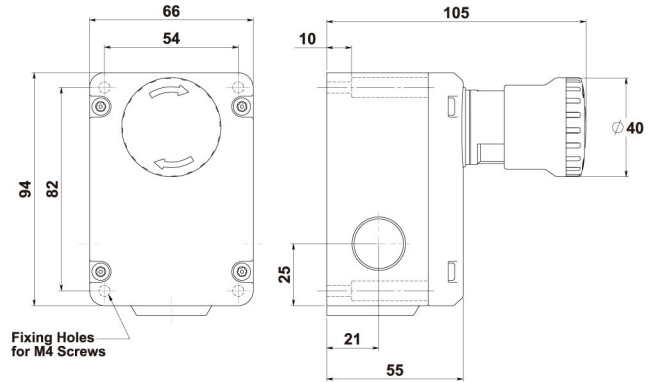

Fixing Holes for M4 Screws

Sales Number	Type	Contacts
232015	ESL-SS(P)-Ex	1NC 1NO
232016	ESL-SS(P)-Ex	2NC
232030	ESL-SS(P)-Ex	2NC 2NO
232007	ESL-SS-Ex	1NC 1NO
232008	ESL-SS-Ex	2NC
232029	ESL-SS-Ex	2NC 2NO

All switches are pre-wired with 3m. length of cabling through the cable glands as shown. Other lengths and cable exits available upon request.

Exd IIC T6 (-20 ≤ Ta ≤ +60C) Gb

Ex tb IIC T85C (-20 ≤ Ta ≤ +60C) Db

Standards: IEC/EN 60079-0 IEC/EN 60079-1
EN1088 IEC 60947-5-1 EN 60204-1
ISO 13849-1 EN62061 EN 954-1 UL508

Safety Classification and Reliability Data:

Mechanical Reliability B10d 1.5 x 10⁶ operations at 100mA load
EN 954-1 up to Category 4 with Safety Relay
ISO 13849-1 up to PLe depending upon system architecture
EN 62061 up to SIL3 depending upon system architecture
Safety Data - Annual Usage 8 cycles per hour / 24 hours per day / 365 days
PFHd <1.0 x 10⁻⁷
Proof Test Interval (Life) 21 years
MTTFd 214 years

Enclosure Protection IP69K IP67
Operating Temperature -20C +60C.
Vibration IEC 68-2-6, 10-55Hz+1Hz, Excursion: 0.35mm, 1 octave/min
Classification Exd IIC T6 (-20 ≤ Ta ≤ +60C) Gb
Ex tb IIC T85C (-20 ≤ Ta ≤ +60C) Db
Rated Voltage 250V a.c
Rated Current 2 Pole 4A.ac 4 Pole 2.5A.ac
Cable length 3m.