

**M18, 100...400mm Diffuse DC**  
**M18, 2m...4m Reflex DC**  
**M18, 16m Through Beam DC**

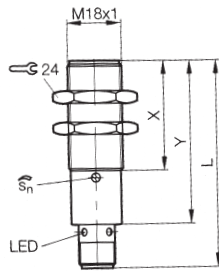

A classic range of connector type diffuse, reflex & through beam industrial sensors, in a M18 metal barrel housing. Diffuse & reflex sensors have potentiometer sensitivity adjustment. Reflex sensors have red light output, for ease of alignment/setup with Polarising filters on the 2m reflex model. These sensors are ideal for harsher ambient conditions. Impervious, rugged, precise and reliable, these sensors are proven in the machine tool industry. Featuring short circuit & reverse polarity protection.

Thread size M18  
 Supply voltage 10-30 volt DC  
 Rated output current 200 mA  
 Temperature -15 to + 55 °C  
 Frequency 100 Hz  
 Sensitivity adj. Potentiometer 0..270°, Diffuse & Reflex only  
 Built in LED Yes  
 IP Rating IP67  
 Body material Nickel plated brass  
 Connection type, Diffuse & Reflex M12 connector, 4 wire type (brown/+ve, blue/-ve, black/NO output, white/NC output)  
 Connection type, Through beam receiver M12 connector, 3 wire type (brown/+ve, black/output, blue/-ve)  
 Connection type, Emitter M12 connector, 2 wire type (brown/+ve, blue/-ve)  
 Also available in stainless steel to IP68 protection  
 Reflex sensors to be used with suitable reflectors.  
 Fibre-optics may be used with-BOS18MPA1PDE5CS4.  
 For mounting clamps please order separately. See below.

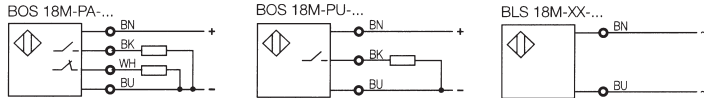

Stock No.	Manufactures Ref'	Type	Output	Voltage	Connection	Range	Unit Price
2668349	BOS18M-PA-1PA-E5C-S4	DIFFUSE	PNP	30VDC	M12 4 PIN	100	67.67
2668355	BOS18M-PA-1PD-E5C-S4	DIFFUSE	PNP	30VDC	M12 4 PIN	400	50.89
2669207	BOS18M-NA-1PD-E5C-S4	DIFFUSE	NPN	30VDC	M12 4 PIN	400	50.89
2668361	BOS18M-PA-1QB-E5C-S4	REFLEX RED	PNP	30VDC	M12 4 PIN	2000	77.29
2669210	BOS18MR-PS-1QB-ESC-S4	REFLEX 90 DEG	PNP DARK ON	30VDC	M12 4 PIN	2000	91.01
2668367	BOS18M-PA-1VD-E5C-S4	REFLEX	PNP	30VDC	M12 4 PIN	4000	95.12
2668627	BOS18-O-KB1	MOUNTING CLAMP					14.15

**M18, 100mm Diffuse DC**  
**Background Suppression**

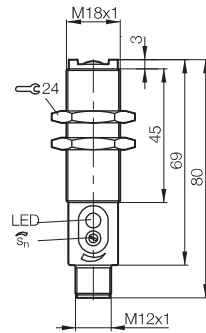

A diffuse photoelectric sensor with background suppression & red light output for ease of alignment/setup. Fine potentiometer adjustment makes it ideal for focussing on small objects. Featuring short circuit & reverse polarity protection.

Thread size M18  
 Nominal sensing range 40...120mm  
 Supply voltage 10-30 volt DC  
 Rated output current 200 mA  
 Temperature -15 to + 55 °C  
 Frequency 600 Hz  
 Sensitivity adjustment Potentiometer 18 turn  
 Built in LED Yes  
 IP Rating IP67  
 Body material Nickel plated brass  
 Connection type M12 connector 4 wire type (brown/+ve, black/NO output white/NC output, blue/-ve)

Stock No.	Manf Ref'	Type	Unit Price
2668343	BOS18M-PA-1HA-S4C	PNP	127.85

**M18, 100mm Diffuse AC**  
**M18, 2m Reflex AC**

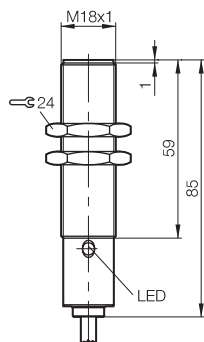

Two AC diffuse & reflex photoelectric sensors in an industry standard M18 metal barrel housing. Fixed ranged, they are ideal for harsher ambient conditions. Impervious & robust with diode bridge output for reliability, these sensors are ideal for a wide variety of applications.

Thread size M18  
 Nominal sensing range 100mm  
 Supply voltage 20-250 volt AC  
 Rated output current 200 mA  
 Temperature -15 to + 55 °C  
 Frequency 10 Hz  
 Sensitivity adjustment Fixed range sensing  
 Built in LED Yes  
 IP Rating IP67  
 Body material Nickel plated brass  
 Connection type Pre-wired, 3 core (0.34mm) PVC cable, 3M (brown/live, black/NO output, blue/neutral)

Stock No.	Manf Ref'	Type	Unit Price
2668385	BOS18M-WS-7XA-BOL3	PNP	57.65
2668379	BOS18M-WO-7RB-BOL3	PNP	57.65