

Key Operated OFF-ON Switch, 20 Amp Key Removable

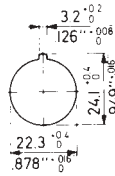
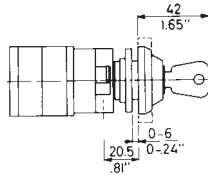

Key operated OFF-ON switches with 60° switching with or without escutcheon. Key is removable in both positions. Single hole Ø22mm mounting suitable for up to 6mm panel thickness. Supplied with key number SF101, although 8 different versions and spares are available.

Rated thermal current 20 A (20 A switch)
 Nominal voltage 690 V
 Rated operational current 20 A (AC21A), 5 A (AC15)
 Dielectric strength 6 kV
 Conforms to IEC 947-3, EN60947-3, VDE 0660 part 107

Stock No.	Manf Ref ¹	Type	Unit Price		
			1-4	5-9	10-24
With Escutcheon Plate					
8901520	CA10A200620FT2V750D/3M 1 POLE		14.48	14.05	13.61
8901523	CA10A201620FT2V750D/3M 2 POLE		15.59	15.12	14.65
Without Escutcheon Plate					
8901526	CA10A200620FT1V750D/3M 1 POLE		13.87	13.45	13.04
8901529	CA10A201620FT1V750D/3M 2 POLE		14.98	14.53	14.08

Key Operated OFF-ON Switch, 20 Amp Key Trapped in ON

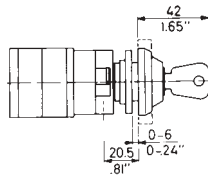

Key operated OFF-ON switches with 60° switching with or without escutcheon. Key is trapped in the 'ON' position and removable in 'OFF'. Single hole Ø22mm mounting suitable for up to 6mm panel thickness. Supplied with key number SF101, although 8 different versions and spares are available.

Rated thermal current 20 A (20 A switch)
 Nominal voltage 690 V
 Rated operational current 20 A (AC21A), 5 A (AC15)
 Dielectric strength 6 kV
 Conforms to IEC 947-3, EN60947-3, VDE 0660 part 107

Stock No.	Manf Ref ¹	Type	Unit Price		
			1-4	5-9	10-24
With Escutcheon Plate					
8901532	CA10A200620FT2V750D/3C 1 POLE		14.48	14.05	13.61
8901535	CA10A201620FT2V750D/3C 2 POLE		15.59	15.12	14.65
Without Escutcheon Plate					
8901538	CA10A200620FT1V750D/3C 1 POLE		13.87	13.45	13.04
8901541	CA10A201620FT1V750D/3C 2 POLE		14.98	14.53	14.08

Key Operated Changeover Switch with Escutcheon Key Removable

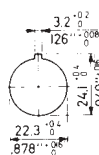
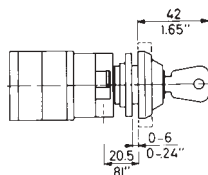

A range of key operated 3 position changeover switches with 60° switching and centre 'OFF', comprising of switch body, escutcheon plate and handle or without escutcheon. One model offers the key to be removable in all positions and the other model offers key trapped in positions 1 & 2. Single hole Ø22mm mounting suitable for up to 6mm panel thickness. Supplied with key number SF101, although 8 different versions and spares are available.

Rated thermal current 20 Amp
 Nominal voltage 690 V
 Rated operational current 20 A (AC21A), 5 A (AC15)
 Motor rating AC-3
 Dielectric strength 6 kV
 Conforms to IEC 947-3, EN60947-3, VDE 0660 part 107

Key Operated Changeover Switch with Escutcheon Key Trapped in 1 & 2



Stock No.	Manf Ref ¹	Type	Unit Price		
			1-4	5-9	10-24
With Escutcheon Plate, Key Removable					
8901544	CA10A210620FT2V750D/3H 1 POLE		15.59	15.12	14.65
8901547	CA10A211620FT2V750D/3H 2 POLE		18.47	17.92	17.36
Without Escutcheon Plate, Key Removable					
8901550	CA10A210620FT1V750D/3H 1 POLE		14.98	14.53	14.08
8901553	CA10A211620FT1V750D/3H 2 POLE		17.86	17.32	16.79
With Escutcheon Plate, Key Trapped 1&2					
8901556	CA10A210620FT2V750D/3C 1 POLE		15.59	15.12	14.65
8901559	CA10A211620FT2V750D/3C 2 POLE		18.47	17.92	17.36
Without Escutcheon Plate, Key Trapped 1&2					
8901562	CA10A210620FT1V750D/3C 1 POLE		14.98	14.53	14.08
8901565	CA10A211620FT1V750D/3C 2 POLE		17.86	17.32	16.79

<< 16