

3 Pole Contactors 4kW & 5.5kW

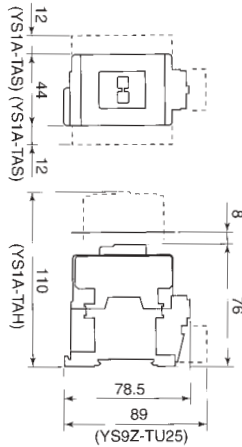

A modern range of DIN rail or screw mounted AC contactors with an integral N/O auxiliary contact rated to 10A (thermal).

Contact configuration 3 pole N/O (main), 1 N/O (auxiliary)
 Rated insulation voltage 690V
 Rated thermal current 20A max.
 Nominal rating 8.4A (4kW), 11A (5.5kW) at 415VAC
 Coil consumption 55VA (inrush), 8VA (hold in)
 Temperature -10°C to +55°C
 Approvals UL, CSA certified, CE marked
 IP Rating IP20

Stock No.	Manf Ref'	Rating	Coil	Unit Price		
				1-4	5-9	10+
5501670	YS1N9F10A024	4KW	24VAC	10.29	9.98	9.67
5501673	YS1N9F10A110	4KW	110VAC	10.29	9.98	9.67
5501676	YS1N9F10A240	4KW	240VAC	10.29	9.98	9.67
5501679	YS1N9F10A415	4KW	415VAC	10.29	9.98	9.67
5501694	YS1N12F10A024	5.5KW	24VAC	12.08	11.72	11.36
5501697	YS1N12F10A110	5.5KW	110VAC	12.08	11.72	11.36
5501700	YS1N12F10A240	5.5KW	240VAC	12.08	11.72	11.36
5501703	YS1N12F10A415	5.5KW	415VAC	12.08	11.72	11.36

3 Pole Contactors 9kW & 11kW

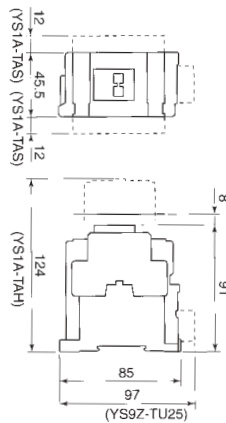
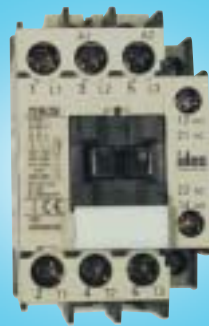

A modern range of DIN rail or screw mounted AC contactors with integral auxiliary contacts (1N/O + 1N/C) rated to 10A (thermal).

Contact configuration 3 pole N/O (main), 1 N/O + 1N/C (auxiliary)
 Rated insulation voltage 1000V
 Rated thermal current 35A max.
 Nominal rating 17A (9kW), 21A (11kW) at 415VAC
 Coil consumption 85VA (inrush), 8VA (hold in)
 Temperature -10°C to +55°C
 Approvals UL, CSA certified, CE marked
 IP Rating IP20

Stock No.	Manf Ref'	Rating	Coil	Unit Price		
				1-4	5-9	10+
5501718	YS1N20F11A024	9KW	24VAC	16.91	16.40	15.90
5501721	YS1N20F11A110	9KW	110VAC	16.91	16.40	15.90
5501724	YS1N20F11A240	9KW	240VAC	16.91	16.40	15.90
5501727	YS1N20F11A415	9KW	415VAC	16.91	16.40	15.90
5501730	YS1N25F11A024	11KW	24VAC	22.94	22.25	21.56
5501733	YS1N25F11A110	11KW	110VAC	22.94	22.25	21.56
5501736	YS1N25F11A240	11KW	240VAC	22.94	22.25	21.56
5501739	YS1N25F11A415	11KW	415VAC	22.94	22.25	21.56

3 Pole Contactors 15kW & 22kW

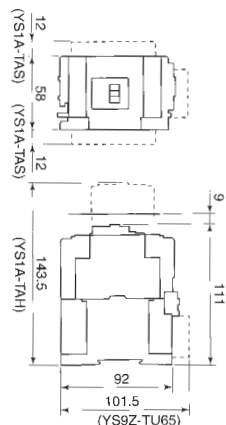
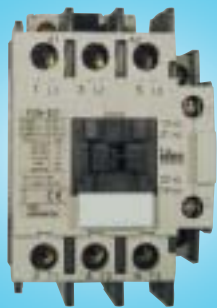

A modern range of DIN rail or screw mounted AC contactors with integral auxiliary contacts (1N/O + 1N/C) rated to 10A (thermal).

Contact configuration 3 pole N/O (main), 1 N/O + 1N/C (auxiliary)
 Rated insulation voltage 1000V
 Rated thermal current 50A (15kW), 60A (22kW)
 Nominal rating 28A (15kW), 40A (22kW) at 415VAC
 Coil consumption 150VA (inrush), 15VA (hold in)
 Temperature -10°C to +55°C
 Approvals UL, CSA certified, CE marked
 IP Rating IP20

Stock No.	Manf Ref'	Rating	Coil	Unit Price		
				1-4	5-9	10+
5501742	YS1N32F11A024	15KW	24VAC	33.81	32.80	31.78
5501745	YS1N32F11A110	15KW	110VAC	33.81	32.80	31.78
5501748	YS1N32F11A240	15KW	240VAC	33.81	32.80	31.78
5501751	YS1N32F11A415	15KW	415VAC	33.81	32.80	31.78
5501754	YS1N38F11A024	22KW	24VAC	48.83	47.37	45.90
5501757	YS1N38F11A110	22KW	110VAC	48.83	47.37	45.90
5501760	YS1N38F11A240	22KW	240VAC	48.83	47.37	45.90
5501763	YS1N38F11A415	22KW	415VAC	48.83	47.37	45.90

3 Pole Contactors 37kW

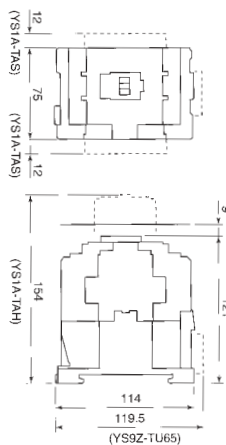

A modern range of DIN rail or screw mounted AC contactors with integral auxiliary contacts (1N/O + 1N/C) rated to 10A (thermal).

Contact configuration 3 pole N/O (main), 1 N/O + 1N/C (auxiliary)
 Rated insulation voltage 1000V
 Rated thermal current 80A max.
 Nominal rating 66A (37kW) at 415VAC
 Coil consumption 170VA (inrush), 16VA (hold in)
 Temperature -10°C to +55°C
 Approvals UL, CSA certified, CE marked
 IP Rating IP20

Stock No.	Manf Ref'	Rating	Coil	Unit Price		
				1-4	5-9	10+
5501778	YS1N65F11A024	37KW	24VAC	80.85	78.42	76.00
5501781	YS1N65F11A110	37KW	110VAC	80.85	78.42	76.00
5501784	YS1N65F11A240	37KW	240VAC	80.85	78.42	76.00
5501787	YS1N65F11A415	37KW	415VAC	80.85	78.42	76.00

3 Pole Contactors 45kW

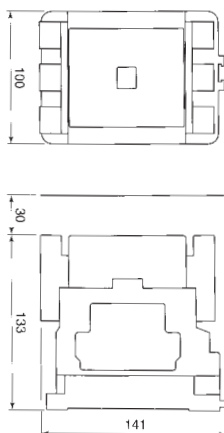

A modern range of DIN rail or screw mounted AC contactors with integral auxiliary contacts (2N/O + 2N/C) rated to 10A (thermal).

Contact configuration 3 pole N/O (main), 2 N/O + 2N/C (auxiliary)
 Rated insulation voltage 1000V
 Rated thermal current 135A max.
 Nominal rating 80A (45kW)
 Coil consumption 350VA (inrush), 66VA (hold in)
 Temperature -10°C to +55°C
 Approvals UL, CSA certified, CE marked
 IP Rating IP20

Stock No.	Manf Ref'	Rating	Coil	Unit Price		
				1-4	5-9	10+
5501790	YS1N80F22A024	45KW	24VAC	110.25	106.94	103.64
5501793	YS1N80F22A110	45KW	110VAC	110.25	106.94	103.64
5501796	YS1N80F22A240	45KW	240VAC	110.25	106.94	103.64
5501799	YS1N80F22A415	45KW	415VAC	110.25	106.94	103.64

3 Pole Contactors 55kW & 63kW

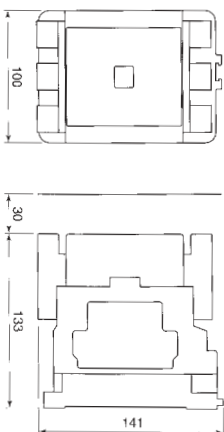

A modern range of DIN rail or screw mounted AC contactors with integral auxiliary contacts (2N/O + 2N/C) rated to 10A (thermal).

Contact configuration 3 pole N/O (main), 2 N/O + 2N/C (auxiliary)
 Rated insulation voltage 1000V
 Rated thermal current 150A max.
 Nominal rating 100A (55kW), 115A (63kW) at 415VAC
 Coil consumption 350VA (inrush), 66VA (hold in)
 Temperature -10°C to +55°C
 Approvals UL, CSA certified, CE marked
 IP Rating IP20

Stock No.	Manf Ref'	Rating	Coil	Unit Price		
				1-4	5-9	10+
5501802	YS1N100F22A024	55KW	24VAC	141.75	137.50	133.25
5501805	YS1N100F22A110	55KW	110VAC	141.75	137.50	133.25
5501808	YS1N100F22A240	55KW	240VAC	141.75	137.50	133.25
5501811	YS1N100F22A415	55KW	415VAC	141.75	137.50	133.25
5501814	YS1N125F22A024	63KW	24VAC	161.70	156.85	152.00
5501817	YS1N125F22A110	63KW	110VAC	161.70	156.85	152.00
5501820	YS1N125F22A240	63KW	240VAC	161.70	156.85	152.00
5501823	YS1N125F22A415	63KW	415VAC	161.70	156.85	152.00

3 Pole Contactors 80kW

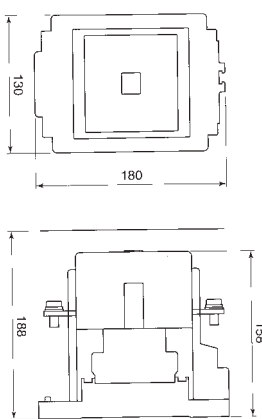
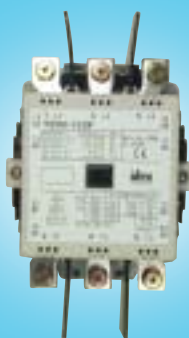

A modern range of DIN rail or screw mounted AC contactors with integral auxiliary contacts (2N/O + 2N/C) rated to 10A (thermal).

Contact configuration 3 pole N/O (main), 2 N/O + 2N/C (auxiliary)
 Rated insulation voltage 1000V
 Rated thermal current 200A max.
 Nominal rating 138A (80kW)
 Coil consumption 819VA (inrush), 53VA (hold in)
 Temperature -10°C to +55°C
 Approvals UL, CSA certified, CE marked
 IP Rating IP20

Stock No.	Manf Ref'	Rating	Coil	Unit Price		
				1-4	5-9	10+
5501826	YS1N150F22A024	80KW	24VAC	174.30	169.07	163.84
5501829	YS1N150F22A110	80KW	110VAC	174.30	169.07	163.84
5501832	YS1N150F22A240	80KW	240VAC	174.30	169.07	163.84
5501835	YS1N150F22A415	80KW	415VAC	174.30	169.07	163.84

Thermal Overload Relay For 4-11kW Contactors

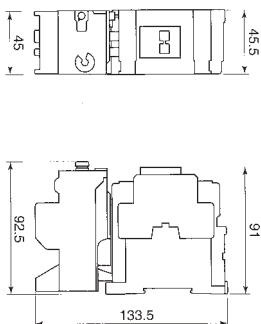
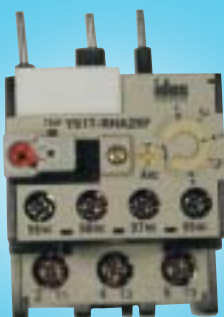

A range of thermal overload relays for direct mounting onto the IDEC range of contactors with integral auxiliary contacts (1N/O + 1N/C).

Single phase protection.
 Class 10.
 3 element type with phase failure protection.
 Manual or automatic reset operation.
 Approvals UL, C-UL certified, CE marked

Stock No.	Manf Ref'	Current range	Unit Price		
			1-4	5-9	10+
5501850	YS1TRHA25FP80D	0.63-1.00A	10.32	10.01	9.70
5501853	YS1TRHA25F1P3D	1.00-1.60A	10.32	10.01	9.70
5501856	YS1TRHA25F1P5D	1.25-2.00A	10.32	10.01	9.70
5501859	YS1TRHA25F2P0D	1.60-2.50A	10.32	10.01	9.70
5501862	YS1TRHA25F3P0D	2.50-4.00A	10.32	10.01	9.70
5501865	YS1TRHA25F5P0D	4.00-6.00A	10.32	10.01	9.70
5501868	YS1TRHA25F7P0D	5.50-8.00A	10.32	10.01	9.70
5501871	YS1TRHA25F8P5D	7.00-10.0A	10.32	10.01	9.70
5501874	YS1TRHA25F11PD	9.00-13.0A	14.24	13.81	13.39
5501877	YS1TRHA25F15PD	12.0-18.0A	14.24	13.81	13.39
5501880	YS1TRHA25F21PD	17.0-25.0A	14.24	13.81	13.39

Dimensions shown when fitted to 11kW contactor

Thermal Overload Relays For 15-22kW Contactors

<3

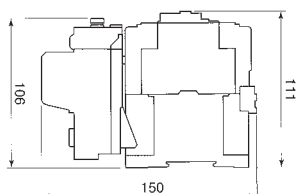

Dimensions shown when fitted to 22kW contactor

A range of thermal overload relays for direct mounting onto the IDEC range of contactors with integral auxiliary contacts (1N/O + 1N/C).

Single phase protection.
Class 10.
3 element type with phase failure protection.
Manual or automatic reset operation.
Approvals UL, C-UL certified, CE marked

Stock No.	Manf Ref ¹	Current range	Unit Price		
			1-4	5-9	10+
5501883	YS1TRHA38F11PD	9.00-13.0A	20.46	19.85	19.23
5501886	YS1TRHA38F15PD	12.0-18.0A	20.46	19.85	19.23
5501889	YS1TRHA38F21PD	17.0-25.0A	20.46	19.85	19.23
5501892	YS1TRHA38F27PD	23.0-32.0A	20.46	19.85	19.23
5501895	YS1TRHA38F32PD	28.0-36.0A	20.46	19.85	19.23
5501898	YS1TRHA38F35PD	30.0-40.0A	20.46	19.85	19.23

Thermal Overload Relays For 25-37kW Contactors

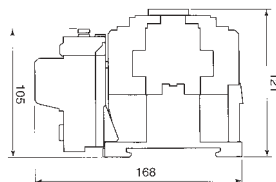
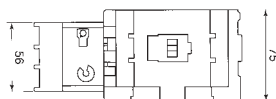

Dimensions shown when fitted to 37kW contactor

A range of thermal overload relays for direct mounting onto the IDEC range of contactors with integral auxiliary contacts (1N/O + 1N/C).

Single phase protection.
Class 10.
3 element type with phase failure protection.
Manual or automatic reset operation.
Approvals UL, C-UL certified, CE marked

Stock No.	Manf Ref ¹	Current range	Unit Price		
			1-4	5-9	10+
5501901	YS1TRHA65F15PD	12.0-18.0A	29.37	28.49	27.61
5501904	YS1TRHA65F21PD	17.0-25.0A	29.37	28.49	27.61
5501907	YS1TRHA65F27PD	23.0-32.0A	29.37	28.49	27.61
5501910	YS1TRHA65F32PD	28.0-36.0A	29.37	28.49	27.61
5501913	YS1TRHA65F35PD	30.0-40.0A	29.37	28.49	27.61
5501916	YS1TRHA65F43PD	37.0-50.0A	29.37	28.49	27.61
5501919	YS1TRHA65F56PD	48.0-65.0A	29.37	28.49	27.61

Thermal Overload Relays For 45-63kW Contactors

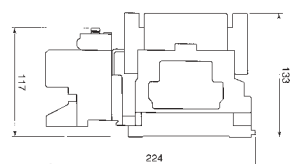
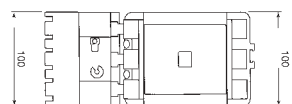

Dimensions shown when fitted to 63kW contactor

A range of thermal overload relays for direct mounting onto the IDEC range of contactors with integral auxiliary contacts (1N/O + 1N/C).

Single phase protection.
Class 10.
3 element type with phase failure protection.
Manual or automatic reset operation.
Approvals UL, C-UL certified, CE marked

Stock No.	Manf Ref ¹	Current range	Unit Price		
			1-4	5-9	10+
5501922	YS1TRHA125F43PD	37.0-50.0A	44.50	43.17	41.83
5501925	YS1TRHA125F56PD	48.0-65.0A	44.50	43.17	41.83
5501928	YS1TRHA125F68PD	55.0-80.0A	44.50	43.17	41.83
5501931	YS1TRHA125F80PD	65.0-95.0A	44.50	43.17	41.83
5501934	YS1TRHA125F105D	85.0-125.0A	44.50	43.17	41.83

Thermal Overload Relays For 80kW Contactors

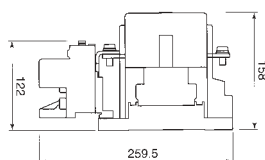
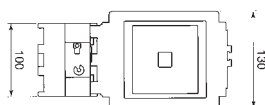
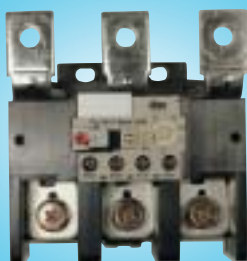

Dimensions shown when fitted to 80kW contactor

A range of thermal overload relays for direct mounting onto the IDEC range of contactors with integral auxiliary contacts (1N/O + 1N/C).

Single phase protection.
Class 10.
3 element type with phase failure protection.
Manual or automatic reset operation.
Approvals UL, C-UL certified, CE marked

Stock No.	Manf Ref ¹	Current range	Unit Price		
			1-4	5-9	10+
5501937	YS1TRHA150F80PD	65.0-95.0A	71.19	69.05	66.92
5501940	YS1TRHA150F105D	85.0-125A	71.19	69.05	66.92
5501943	YS1TRHA150F135D	105-160A	71.19	69.05	66.92

Mechanical Interlock Blocks for IDEC 3 Pole Contactors

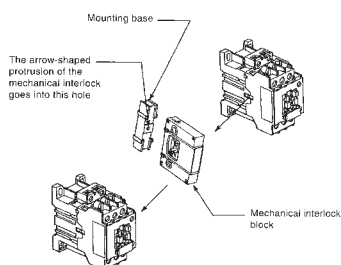

Mechanical interlock blocks are used to prevent two contactors from closing at the same time. Typical use is when one contactor is used for reversing. Compact and easy to mount.

For 4kW-37kW contactors, use interlock block YS9ZTMI65
For 45kW-160kW contactors, use interlock block YS9ZTMI125

Approvals UL, CSA certified, CE marked

Stock No.	Manf Ref'	Type	Unit Price		
			1-4	5-9	10+
5501973	YS9ZTMI65	4kW-37kW	3.13	3.04	2.94
5501976	YS9ZTMI125	45kW-160kW	9.43	9.15	8.86

Auxiliary Contact Blocks for IDEC 3 Pole Contactors

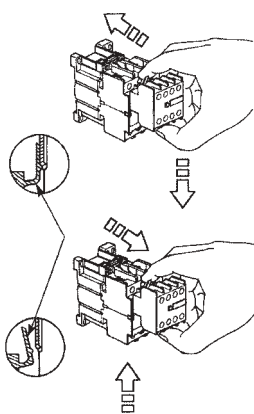
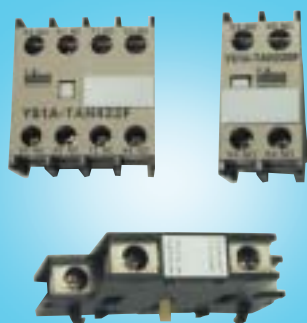

Mounting & Removing Front mounted Auxiliary Blocks

Auxiliary contact blocks for contactors of up to 37kW rating. Top mounting or side mounting versions with various contact configurations.

Rated Voltage 600V
Rated thermal current 10A
Min. switching capacity 10mA at 24V
Approvals UL, CSA certified, CE marked

Stock No.	Manf Ref'	Mount	Contacts	Unit Price		
				1-4	5-9	10+
5501946	YS1ATAH202F	TOP	2 N/C	4.60	4.46	4.32
5501949	YS1ATAH211F	TOP	1N/O+1 N/C	4.60	4.46	4.32
5501952	YS1ATAH220F	TOP	2 N/O	4.60	4.46	4.32
5501955	YS1ATAH404F	TOP	4 N/C	8.24	7.99	7.75
5501958	YS1ATAH413F	TOP	1 N/O+3 N/C	8.24	7.99	7.75
5501961	YS1ATAH422F	TOP	2 N/O+2 N/C	8.24	7.99	7.75
5501964	YS1ATAH431F	TOP	3 N/O+1 N/C	8.24	7.99	7.75
5501967	YS1ATAH440F	TOP	4 N/O	8.24	7.99	7.75
5501970	YS1ATAS211F	SIDE	1 N/O+1 N/C	4.60	4.46	4.32

Reversing Contactor Wire Kits

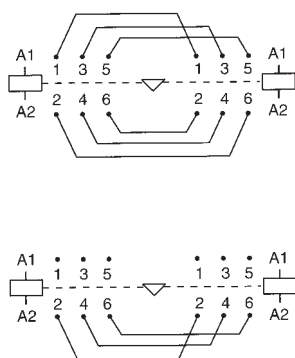
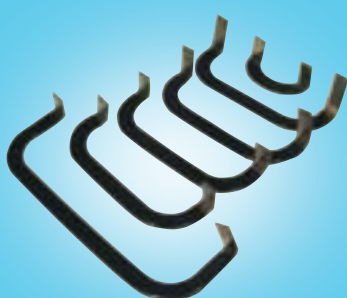

Connection Kit Wiring Diagram

Connection kits to allow for easy wiring of reversing contactor assemblies. Each kit contains 6 pre-cut wires.

Stock No.	Manf Ref'	Type	Unit Price		
			1-4	5-9	10+
5501979	YS9ZKIF411344A	4kW-5.5kW	7.28	7.06	6.84
5501982	YS9ZKIF411345A	9kW-11kW	18.36	17.81	17.26
5501985	YS9ZKIF411346A	15kW-22kW	24.86	24.11	23.37
5501988	YS9ZKIF411347A	25kW-37kW	36.73	35.63	34.53
5501991	YS9ZKIF411348A	45kW-63kW	130.83	126.91	122.98
5501994	YS9ZKIF411388A	80kW	158.35	153.60	148.85

Star Delta Timer (TQR 1)

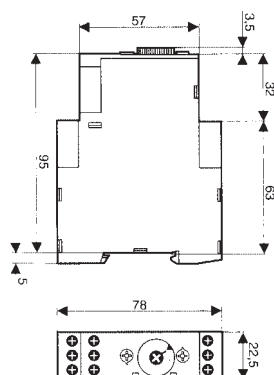

DIN rail mounted 22.5mm star delta electronic timer with 2 N/O contacts. Upon energisation the star relay pulls in for the duration of the set star time. At the end of this time the star relay de-energises, and after a further dwell delay, the delta relay energises and is maintained until the power supply is removed.

Operating range 85 to 110% of nominal voltage
Contact rating 8A at 250V AC/DC
Star timing ranges 0.1-1s, 1-10s, 6-60s, 1-10min, 6-60min
1-10h, 10-100h
Dwell time 20/40/60/80/100/120/140ms (selectable)
Repetition accuracy ± 0.5% of set time
Electrical life 10⁵
Dielectric strength 2.5kVAC
Display LED Flashing green/on, yellow/timing green/operated
Temperature -20°C to + 60°C
Approvals UL, CSA

Stock No.	Manf Ref'	Type	Unit Price		
			1-4	5-9	10-24
3262112	88 865 175	24VDC, 24-240VAC	26.99	25.37	24.02